

8952 E Desert Cove

Scottsdale, AZ 85260



TRANSWESTERN

REAL ESTATE
SERVICES



Kathleen Morgan

Senior Vice President

1 602 809 1048

kathleen.morgan@transwestern.com

Kevin Smigiel

Vice President

1 602 550 9295

kevin.smigiel@transwestern.com

The information provided herein was obtained from sources believed reliable; however, Transwestern makes no guarantees, warranties or representations as to the completeness or accuracy thereof. The presentation of this property is submitted subject to errors, omissions, change of price or conditions, prior sale or lease, or withdrawal without notice. Copyright © 2025 Transwestern.



Scottsdale Shea Medical Plaza

8952 E Desert Cove, Scottsdale AZ 85260

Lease Rate: \$32.00 PSF

(MG, Net of Elec. & Janitorial)

Kathleen Morgan

Senior Vice President

1 602 809 1048

kathleen.morgan@transwestern.com

Kevin Smigiel

Vice President

1 602 550 9295

kevin.smigiel@transwestern.com

The information provided herein was obtained from sources believed reliable; however, Transwestern makes no guarantees, warranties or representations as to the completeness or accuracy thereof. The presentation of this property is submitted subject to errors, omissions, change of price or conditions, prior sale or lease, or withdrawal without notice. Copyright © 2025 Transwestern.



1st Floor

Suite E205 - ±3,587 SF - Dental Suite

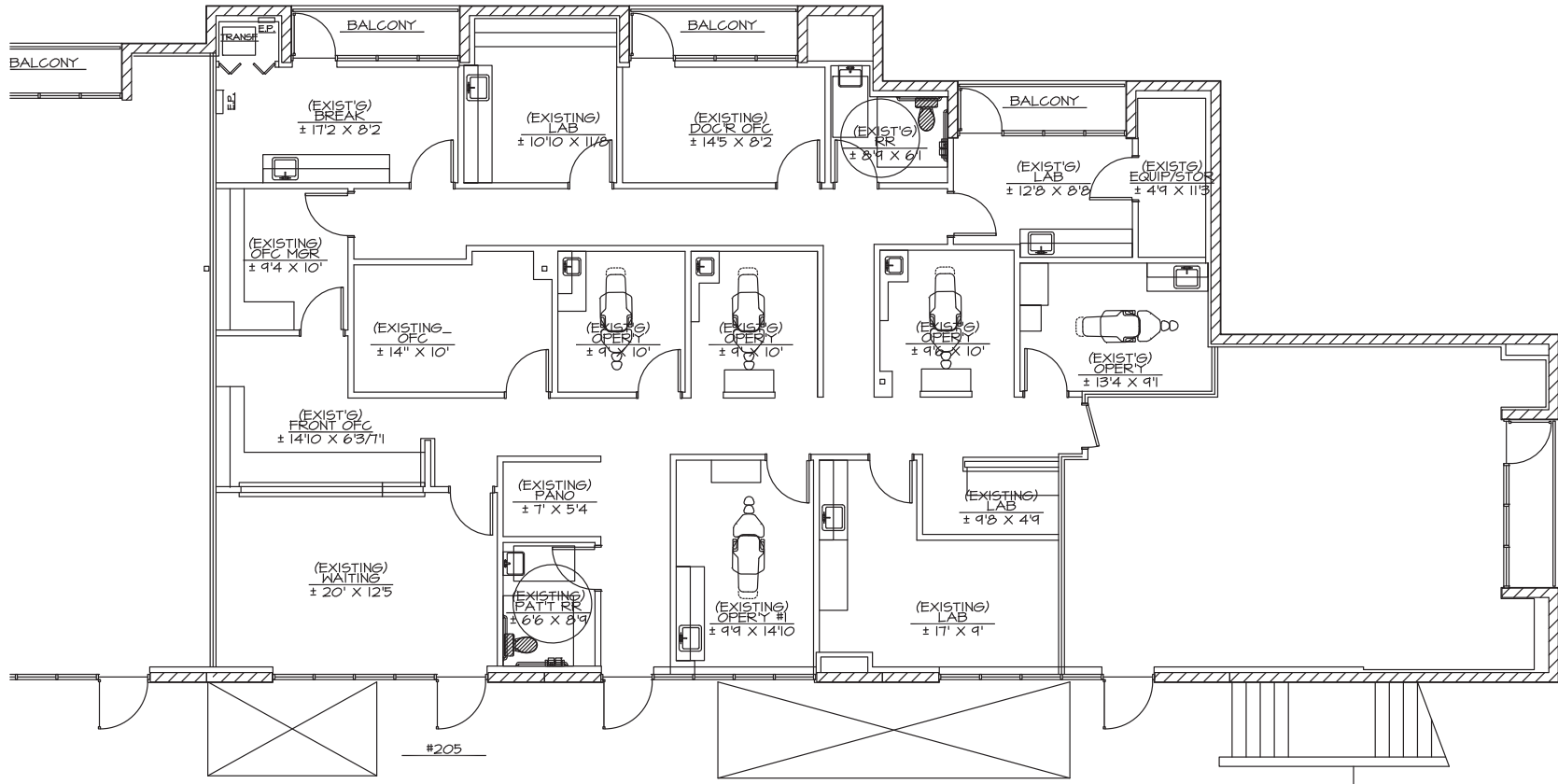

Kathleen Morgan

Senior Vice President

1 602 809 1048

kathleen.morgan@transwestern.com

Kevin Smigiel

Vice President

1 602 550 9295

kevin.smigiel@transwestern.com

The information provided herein was obtained from sources believed reliable; however, Transwestern makes no guarantees, warranties or representations as to the completeness or accuracy thereof. The presentation of this property is submitted subject to errors, omissions, change of price or conditions, prior sale or lease, or withdrawal without notice. Copyright © 2025 Transwestern.



TRANSWESTERN

REAL ESTATE
SERVICES



Scottsdale Shea Medical Plaza
8952 E Desert Cove
Scottsdale, AZ 85260

HONORHEALTH®
Scottsdale Shea Medical Center

Scottsdale Fiesta Shopping Center

BARNES & NOBLE BOOKSELLERS BIG LOTS! buybuy BABY DUNKIN' DONUTS DSW

Fry's HomeGoods® THE HOME DEPOT IHOP

Marshall's OfficeMax

PET SMART Portillo's BUT DOGS, BEEF, BURGERS, SALADS Vopars GREENE & PEASANTS WINN-DIXIE

- Just off Loop 101, north of Shea Blvd.
- ¼ mile from HonorHealth Scottsdale Shea Hospital
- Excellent mix of medical, dental and office tenants
- In proximity to numerous restaurant and retail amenities
- New Ownership
- Strong traffic counts along Shea Blvd. & Pima Freeway

Kathleen Morgan
Senior Vice President
1 602 809 1048
kathleen.morgan@transwestern.com

Kevin Smigiel
Vice President
1 602 550 9295
kevin.smigiel@transwestern.com

The information provided herein was obtained from sources believed reliable; however, Transwestern makes no guarantees, warranties or representations as to the completeness or accuracy thereof. The presentation of this property is submitted subject to errors, omissions, change of price or conditions, prior sale or lease, or withdrawal without notice. Copyright © 2025 Transwestern.

