

COMING Q1 2026 | MEDICAL OFFICE BUILDING



SIERRA BLOOM

FUTURE SIGNAGE

TRANSWESTERN REAL ESTATE SERVICES

**FOR LEASE**

**90TH ST & LOOP 101 SCOTTSDALE, AZ**

Developed By:





# SIERRA BLOOM

## OVERVIEW

- Approximately 900,000 SF of medical, assisted living, behavioral health hospital, imaging, ambulatory surgery center, urgent care, hotel and retail facilities.
- Patient care and hospitality space across ±40 acres
- Large scale project opens unprecedented opportunities for collaboration.
- Walkable campus, prominent wayfinding, easy access, identifiable buildings, and tenant spaces with integrated environmental landscapes.

**LEASE RATE: \$35.00/SF NNN**

## HIGHLIGHTS

- More than half the building is preleased to an Anchor Tenant
- Q1 2026 Occupancy
- ±32,232 SF Total. 2 Stories, ±16,116 SF floor plate.
- Approximately 10,000 SF Available (Divisible to ±2,000 SF).
- 5:1,000 Parking ratio
- Freeway visibility
- Class A multi-tenant medical building with primary care and other specialty physician groups
- 3-minute drive to HonorHealth Shea Campus
- State of the art infrastructure

## SIERRA BLOOM MASTER PLAN

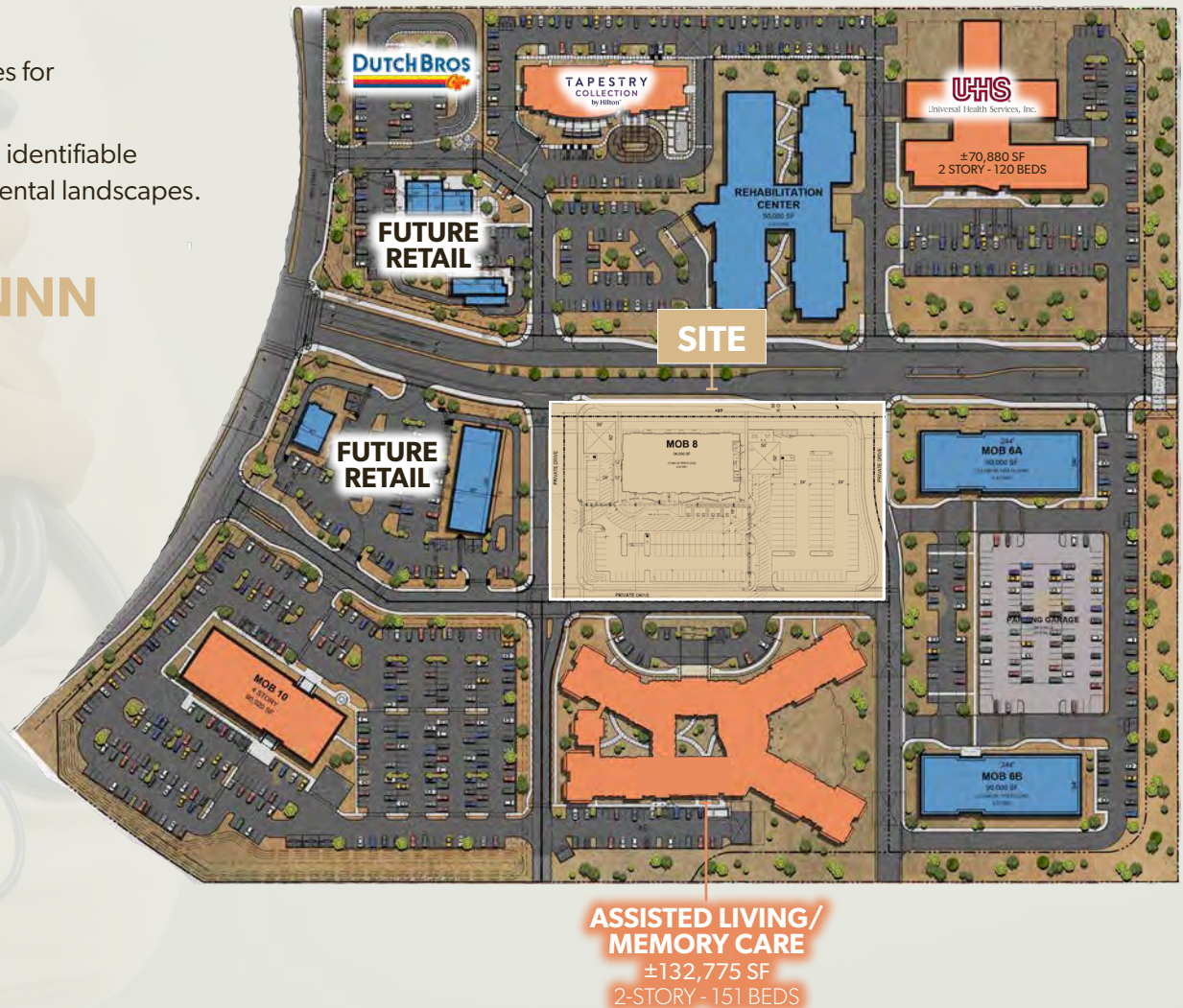



# FIRST FLOOR LEASE EXHIBIT & STACKING PLAN

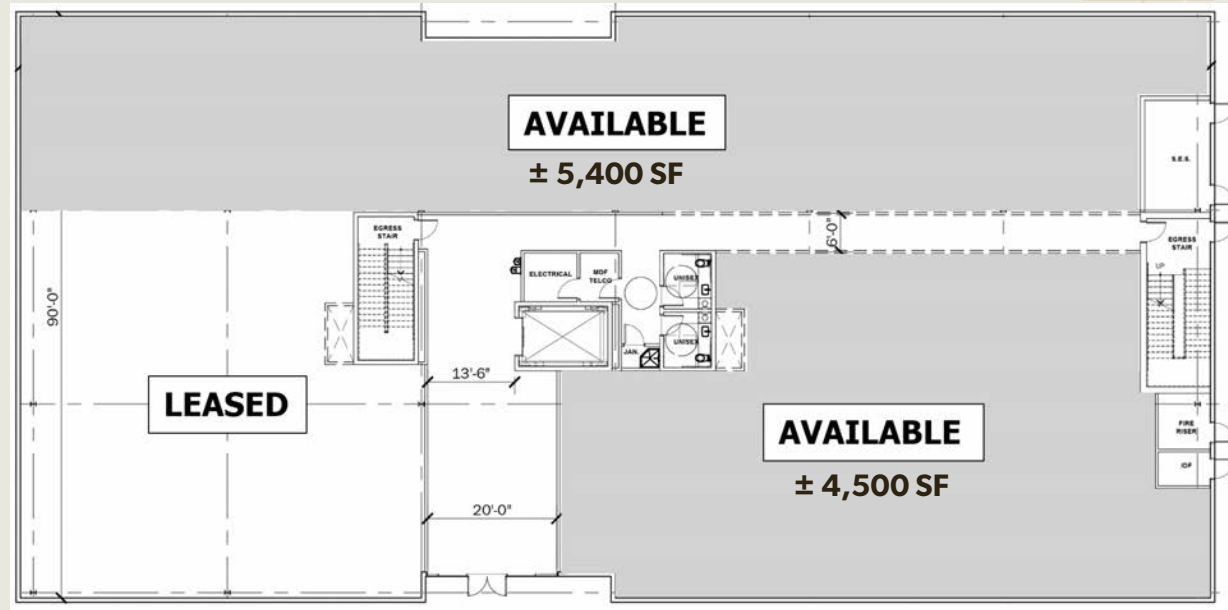

# SITE PLAN

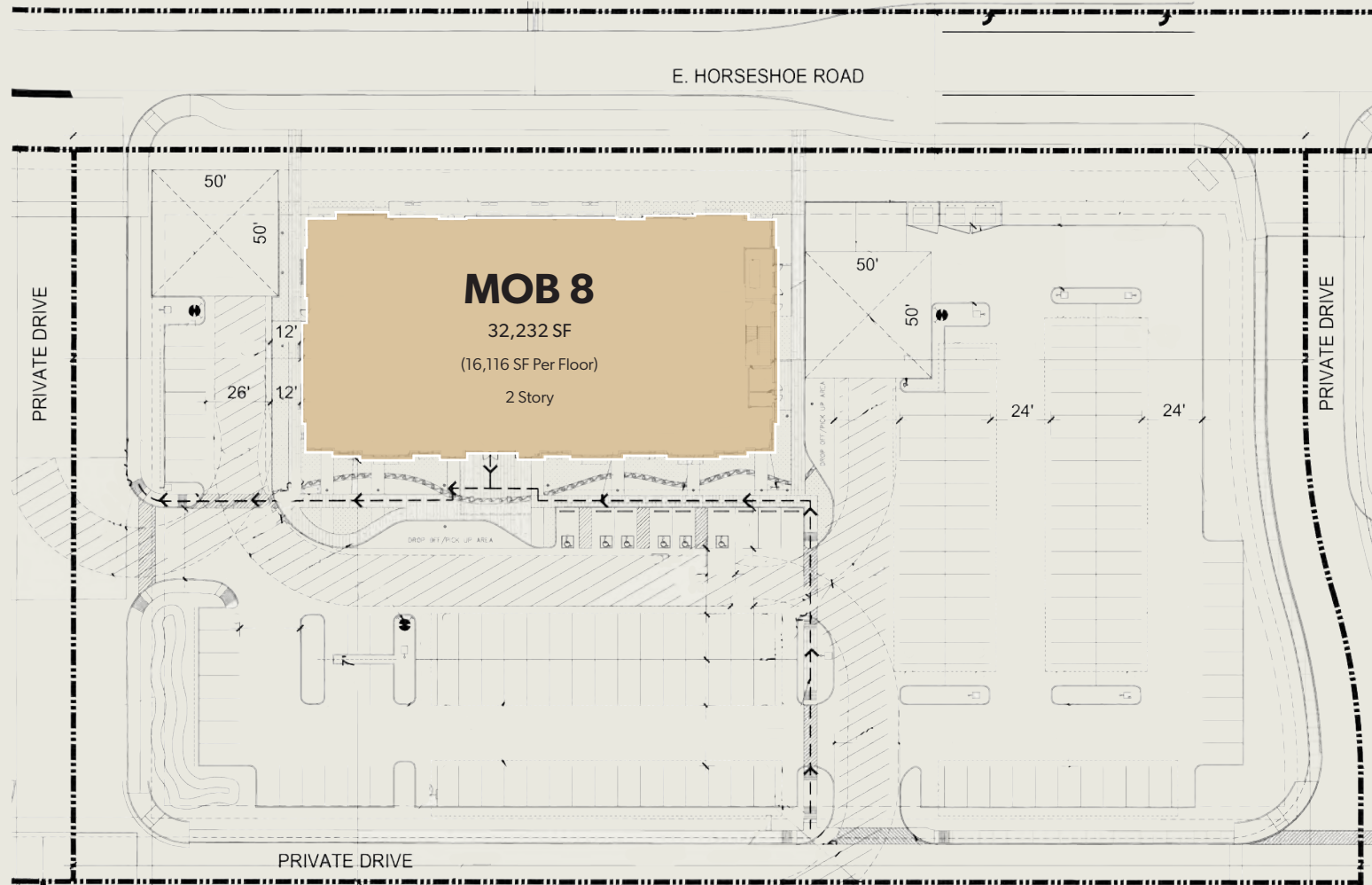



# WHY SCOTTSDALE?

## DEMOGRAPHICS | 15-MIN DRIVE TIME

- 2024 Population | 146,060
- 2024 Median Age | 49.3
- Avg Household Size | 2.08
- Avg Household Income | \$172,171
- Median Home Value | \$708,406
- Consumer Expenditure on Health Care | \$779,344,622 annually
- Health Care Market Potential | 105,852 residents visited a doctor in the past 12 months

## LOCATION | UNEQUALED PRESTIGE

- The Sierra Bloom campus is ideally located in the affluent North Scottsdale
- Just south of the HonorHealth Shea Medical Center
- Designed for patient comfort, ease, and accessibility
- Excellent access from all areas of Greater Phoenix
- ±15 minutes to Phoenix Sky Harbor Airport





101

HONORHEALTH SCOTTSDALE  
THOMPSON PEAK MEDICAL 9 MI

HONORHEALTH LAND 8.5 MI

MAYO  
HOSPITAL 10 MI

BANNER HEALTH  
DEVELOPMENT 8 MI

ABRAZO SCOTTSDALE  
CAMPUS 11 MI

# 6 NEARBY HOSPITAL SYSTEMS

101

5 MI MAYO CLINIC/SHEA  
CAMPUS

HONORHEALTH SCOTTSDALE  
SHEA MEDICAL CENTER 1 MI

8 MI HONORHEALTH SCOTTSDALE  
OSBORN MEDICAL CENTER







MAYO HOSPITAL



SCOTTSDALE THOMPSON  
PEAK MEDICAL CENTER



SCOTTSDALE SHEA  
MEDICAL CENTER



MAYO CLINIC

101

FULL DIAMOND  
INTERCHANGE



SIERRA BLOOM

FOR MORE  
INFORMATION:

**VINCE FEMIANO**  
602.954.7559  
vince.femiano@transwestern.com

**KEVIN SMIGIEL**  
602.265.5502  
kevin.smigiel@transwestern.com

**KATE MORRIS**  
602.296.6369  
kate.morris@transwestern.com

DEVELOPED BY:



TRANSWESTERN REAL ESTATE SERVICES

© 2024 All rights reserved. This information has been obtained from sources believed reliable, but has not been verified for accuracy or completeness. Any projections, opinions, or estimates are subject to uncertainty. The information may not represent the current or future performance of the property. You and your advisors should conduct a careful, independent investigation of the property and verify all information. Any reliance on this information is solely at your own risk. Transwestern and the Transwestern logo are service marks of Transwestern, Inc. All other marks displayed on this document are the property of their respective owners. Photos herein are the property of their respective owners. Use of these images without the express written consent of the owner is prohibited.