

# 16848 E PALISADES BLVD

FREE STANDING  
OWNER/USER  
BUILDING  
**FOR LEASE**

**NEW REDUCED RATE!**



 **TRANSWESTERN** REAL ESTATE SERVICES

16848 E PALISADES BLVD – FOUNTAIN HILLS AZ 85268

## BUILDING FEATURES

- Former Mayo Clinic & Administrative Use
- Size: 7,568 SF
- Land Site: 1.98 Acres
- Zoned: C2
- Great Visibility: Frontage - E Palisades Rd
- Parcel # - 176-96-954
- Year Built: 1996
- Use: Medical, Office, Retail or other

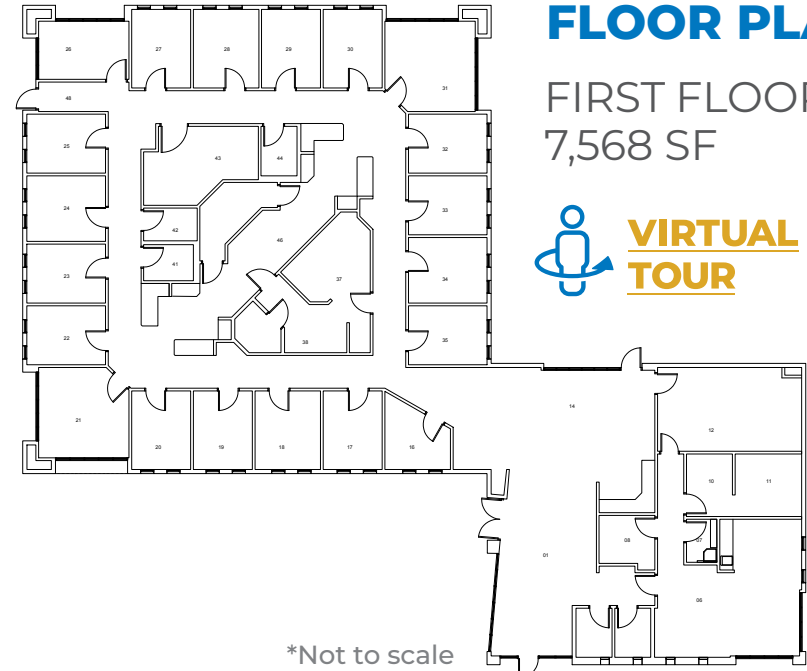

## NOW AVAILABLE

FOR LEASE: \$16.00/SF NNN

## FOUNTAIN HILLS DEMOGRAPHICS



POPULATION

**31,122**



MEDIAN HOUSEHOLD INCOME

**\$94,648**

### POPULATION BY AGE

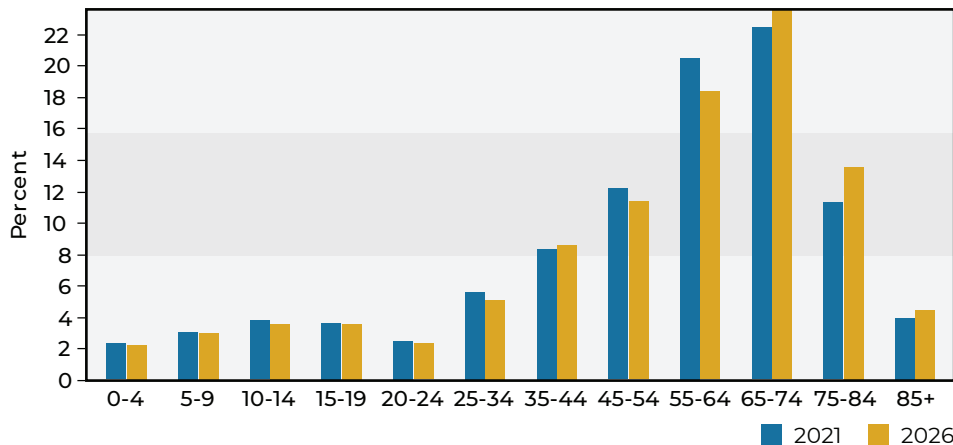

### TRENDS 2021-2026

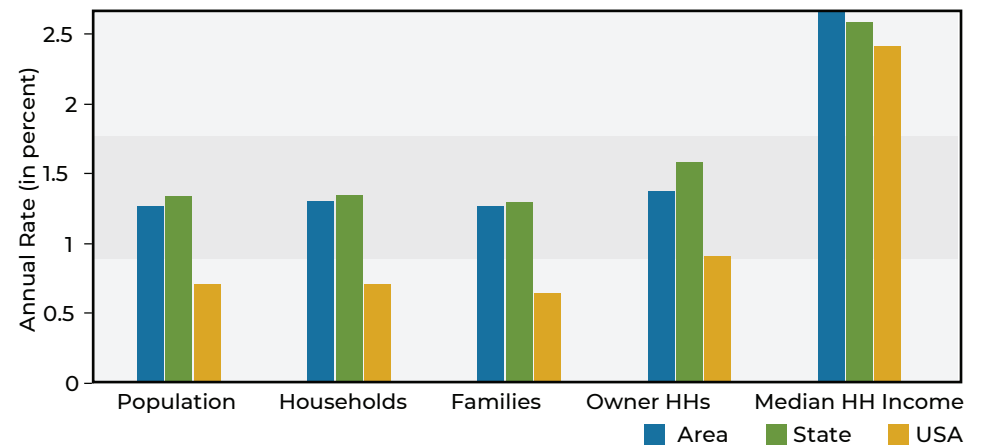



**W SAGUARO BLVD**

**E PALISADES BLVD**

HONORHEALTH

Urgent Care - Fountain Hills

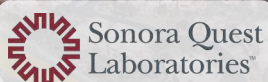

**For additional information:**

**KEVIN SMIGIEL**

Vice President  
602.265.5502  
kevin.smigiel@transwestern.com

**VINCE FEMIANO**

Senior Vice President  
602.954.7559  
vince.femiano@transwestern.com

2501 East Camelback Road, Suite 1  
Phoenix, Arizona 85016  
T 602.956.5000 F 602.956.5333  
[transwestern.com](http://transwestern.com)

