

FOR SALE

TURNKEY SOON-TO-BE-VACANT DEALERSHIP

19300 NORTHWEST FWY

HOUSTON, TEXAS 77065

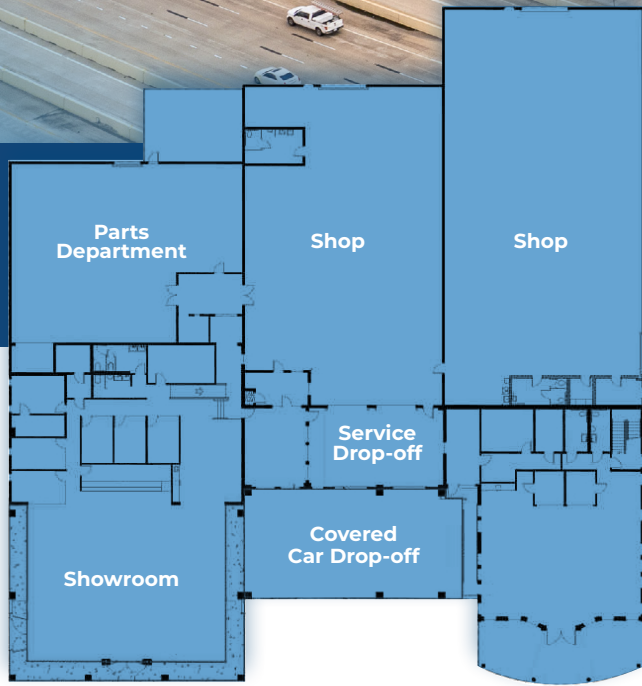

FLOOR PLAN

19300 Northwest Fwy is a soon-to-be vacant dealership constructed in 1986 in Northwest Houston near the bustling intersection of Highway 290 and FM 1960.

PROPERTY AT-A-GLANCE

Acreage	5.187 AC Main Lot
	8.121 AC Satellite Lot
	13.308 AC Total
Building Floors / SF	1.5 Floors / 29,750 RSF
Year Built / Updated	1986 / 2021
Highlights	Formerly Northwest Hyundai
	Parking for 335 cars (plus additional space available behind fence)
	Separate satellite lot located 1 mile away (can be added to transaction or sold separately)
Traffic Count	158,700+ cars per day

Note: Figures above are approximate. Buyer to verify.

PURCHASE TERMS

Asking Price	Contact broker
Commission to Buyer's Broker	Contact broker

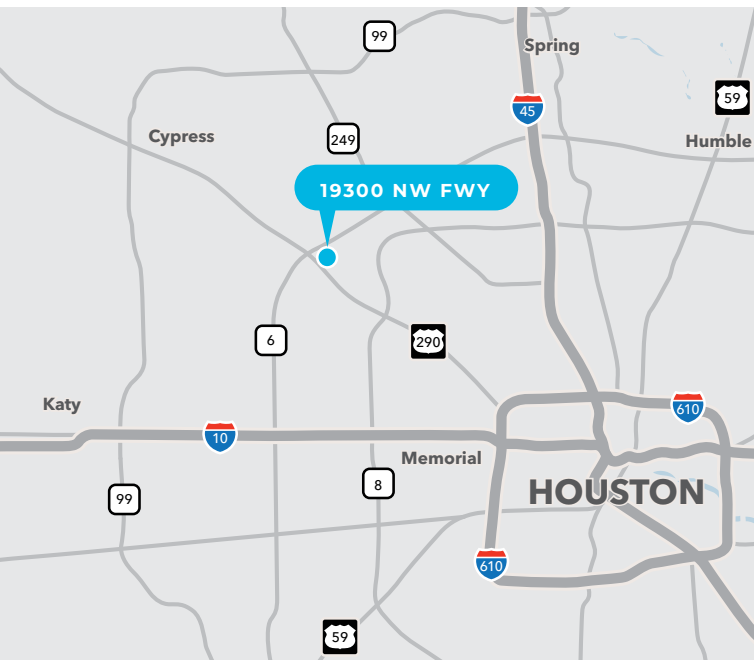

FOR MORE INFORMATION & CONFIDENTIALITY AGREEMENT:



EVELYN WARD, CCIM

Senior Vice President

713.270.3352

Evelyn.Ward@transwestern.com